

Lucky Clover Block

Skill Level
CONFIDENT BEGINNER

Finished Block Size
12" x 12"

Cutting Instructions
(cut in order listed)

Light green print/texture (background)

8 squares $3\frac{1}{2}$ " x $3\frac{1}{2}$ "

8 squares $2\frac{1}{2}$ " x $2\frac{1}{2}$ "

8 squares $1\frac{1}{2}$ " x $1\frac{1}{2}$ "

Medium green print/texture and dark green print/texture (leaves)—cut from each:

4 rectangles $3\frac{1}{2}$ " x $6\frac{1}{2}$ "

Piecing the Block

1 Draw diagonal line on wrong side of light green $2\frac{1}{2}$ " square. Referring to **Diagram I-A**, place marked square on corner of medium green rectangle, right sides together, aligning raw edges. Stitch on drawn line; trim away and discard excess fabric. Open and press. Using light green $1\frac{1}{2}$ " square, repeat on adjoining corner to make medium pieced rectangle. Make 4. In similar manner, but reversing placement of light squares, make 4 dark pieced rectangles (**Diagram I-B**).

2 Aligning as shown in **Diagram II**, stitch light $3\frac{1}{2}$ " square to medium pieced rectangle to make medium pieced unit. Make 4. In same manner, but reversing placement of square, stitch light $3\frac{1}{2}$ " square to dark pieced rectangle to make dark pieced unit. Make 4.

3 On wrong side of medium pieced unit, draw a line from corner of $3\frac{1}{2}$ " square to bottom corner of medium rectangle (**Diagram III**). Place marked medium pieced unit on dark pieced unit, right sides together, aligning raw edges. Stitch on drawn line; trim away and discard excess fabric. Open and press to make quarter-block. Make 4.

4 Referring to **Diagram IV** and watching orientation, stitch 2 rows of 2 quarter-blocks each. Sew rows together to make Lucky Clover Block.

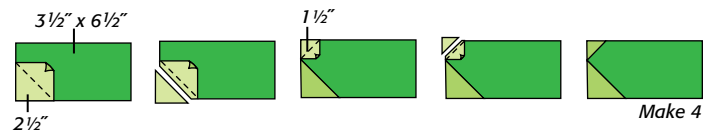

Diagram I-A

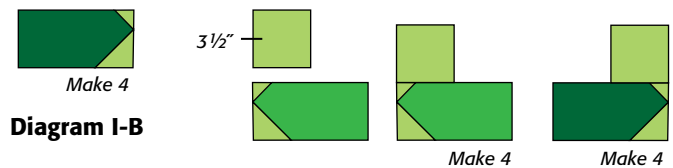

Diagram I-B

Diagram II

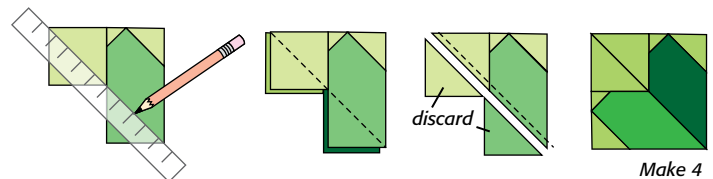

Diagram III

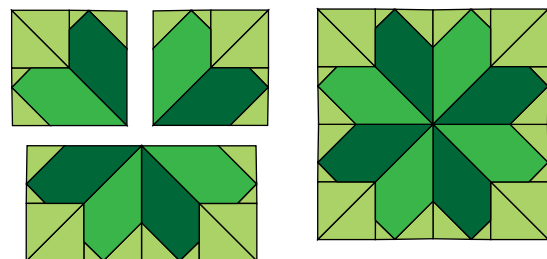

Diagram IV